

CBZ Right-angle clevis foot

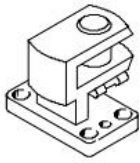

The pivot pin is secured against rotation with a spring pin.

Material:

Spheroidal graphite cast iron

Type: CBZ-32/40/50/63/80/100/125

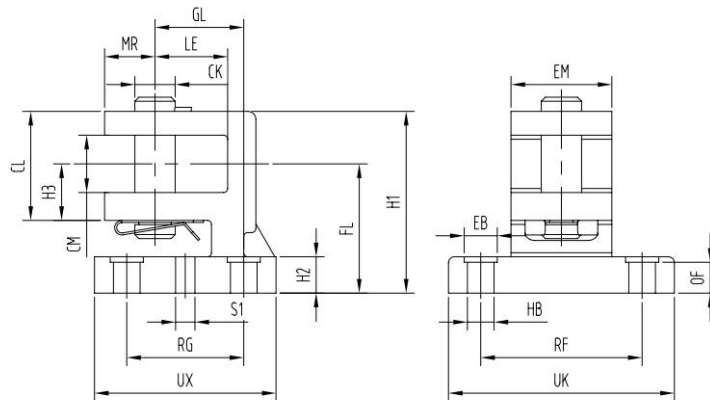

For diameter Ø[mm]	CK $\text{h}9$	CL	CM+0.2	EB Ø	EM	FL	GL	H1	H2	H3
32	10	27	14.2	11	25	32 ±0.3	22 ±0.3	45 ±0.5	9	14
40	12	31	16.2	11	25	36js14	22js14	52 ±0.5	9	15
50	16	41	21.2	15	32	45js14	36js14	66 ±0.5	9	20
63	16	41	21.2	15	36	50js14	38js14	71	12	20
80	20	51	25.1	18	36	63js14	39js14	89	14	25
100	20	51	25.1	18	42	71js14	51js14	97	14	25
125	30	80	37.1	19	50	90 ±0.4	60js14	130	20	40

For diameter Ø[mm]	HB Ø	LE	MR	RF	RG	S1 Ø	UK	UX	Type
32	6.6	18	12.5	40 ±0.3	29 ±0.3	4.8	56	45	CBZ-32
40	6.6	22	15	40js14	29js14	5.8	56	45	CBZ-40
50	9	28	18	52js14	40js14	5.8	70	58	CBZ-50
63	9	28	18	57js14	47js14	7.8	75	65	CBZ-63
80	11	31	20	58js14	48js14	9.8	80	70	CBZ-80
100	11	34	22	64js14	54js14	9.8	90	80	CBZ-100
125	14	38	32	104js14	70js14	11.5	130	96	CBZ-125